

**WORK PACKAGE B - RECREATION CENTRE**  
 Alterations to existing ramp and paraplegic toilet.  
 1. No electrical work required for the access ramp.  
 2. Paraplegic Toilet:  
 • Identify and make safe existing light circuit.  
 • Remove existing light switch, conduit box and wiring between switch and light fitting.  
 • Chase conduit in wall to new light switch position, at lower level of +1000 AFRL to top of switch cover plate.  
 • Supply and install new conduit box and 1 layer, 1 way light switch. Wire the switch to match existing.  
 • Builder to patch wall where chasing occurs.  
 3. Test and commission the installation. Provide a Certificate of Compliance as per SANS 10142.

**Electrical Summary:**  
 Existing Distribution Board DB50  
 Fed from:  
 No changes to be required

**Additional Load:** 0 W - None  
 Wiring Size: 2 x 2.5mm<sup>2</sup> phase conductors + 2.5mm<sup>2</sup> earth wire  
 Conduit Size: 20mm diameter

**WORK PACKAGE 1 - LOGISTICS**  
 New paraplegic ramp, balustrades and warning detection and new paraplegic ablutions  
 1. No electrical work required for the access ramps.  
 2. Paraplegic Toilet:  
 • Identify and make safe existing light circuit.  
 • Remove existing light switch, conduit box and wiring between switch and light fitting.  
 • Chase conduit in wall to new light switch position, at lower level of +1000 AFRL to top of switch cover plate and 20mm from edge of door frame.  
 • Supply and install new conduit box and 1 layer, 1 way light switch. Wire the new switch to the light fitting.  
 • Builder to patch wall where chasing occurs.  
 3. Test and commission the installation. Provide a Certificate of Compliance as per SANS 10142.

**Electrical Summary:**  
 Existing Distribution Board DB57  
 Fed from:  
 No changes to be required

**Additional Load:** 0 W - none  
 Wiring Size: 2 x 2.5mm<sup>2</sup> phase conductors + 2.5mm<sup>2</sup> earth wire  
 Conduit Size: 20mm diameter

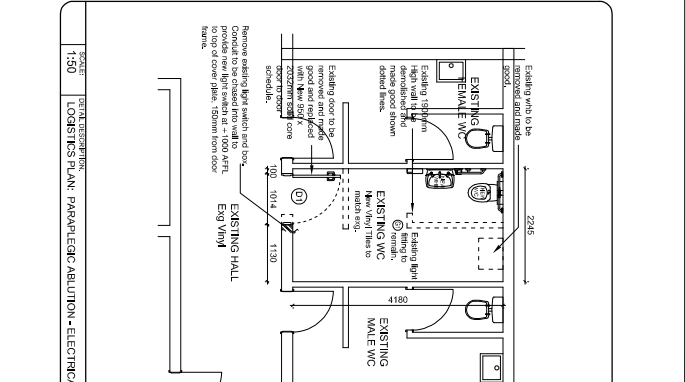

**WORK PACKAGE B - RECREATION CENTRE**  
 Alterations to existing ramp and paraplegic toilet.  
 1. No electrical work required for the access ramp.  
 2. Paraplegic Toilet:  
 • Identify and make safe existing light circuit.  
 • Remove existing light switch, conduit box and wiring between switch and light fitting.  
 • Chase conduit in wall to new light switch position, at lower level of +1000 AFRL to top of switch cover plate.  
 • Supply and install new conduit box and 1 layer, 1 way light switch. Wire the switch to match existing.  
 • Builder to patch wall where chasing occurs.  
 3. Test and commission the installation. Provide a Certificate of Compliance as per SANS 10142.

**Electrical Summary:**  
 Existing Distribution Board DB50  
 Fed from:  
 No changes to be required

**Additional Load:** 0 W - none  
 Wiring Size: 2 x 2.5mm<sup>2</sup> phase conductors + 2.5mm<sup>2</sup> earth wire  
 Conduit Size: 20mm diameter

**WORK PACKAGE 1 - LOGISTICS**  
 New paraplegic ramp, balustrades and warning detection and new paraplegic ablutions  
 1. No electrical work required for the access ramps.  
 2. Paraplegic Toilet:  
 • Identify and make safe existing light circuit.  
 • Remove existing light switch, conduit box and wiring between switch and light fitting.  
 • Chase conduit in wall to new light switch position, at lower level of +1000 AFRL to top of switch cover plate and 20mm from edge of door frame.  
 • Supply and install new conduit box and 1 layer, 1 way light switch. Wire the new switch to the light fitting.  
 • Builder to patch wall where chasing occurs.  
 3. Test and commission the installation. Provide a Certificate of Compliance as per SANS 10142.

**Electrical Summary:**  
 Existing Distribution Board DB57  
 Fed from:  
 No changes to be required

**Additional Load:** 0 W - none  
 Wiring Size: 2 x 2.5mm<sup>2</sup> phase conductors + 2.5mm<sup>2</sup> earth wire  
 Conduit Size: 20mm diameter

**LEGEND & NOTES**

**ELECTRICAL LEGEND:**  
 1. 20mm Ø - Round Recessed and made good with accurate FFL to the top of the cover plate.  
 2. FFL 50mm height  
 3. Light switch - 1 Layer, 1 Way switching

**ELECTRICAL NOTES:**  
 - All light switches and access control systems shall be horizontally aligned with door handles (i.e. +1000mm above FFL to the top of the cover plate).  
 - Recessed action, toggle or push-and-switches that operate in light switches shall project clear of the switch plate and shall have a width of at least 10mm.  
 - New general purpose sockets (unless lower rating) shall be fixed at least 500mm above the finished floor level.  
 - All electrical work shall be done in accordance with the relevant parts of the SANS 10142-1:2012 and SANS 10142-2:2012.

**GENERAL NOTES**

- All electrical work shall be done in accordance with the relevant parts of the SANS 10142-1:2012 and SANS 10142-2:2012.
- The contractor shall be responsible for the provision of the relevant parts of the SANS 10142-1:2012 and SANS 10142-2:2012.
- The contractor shall be responsible for the provision of the relevant parts of the SANS 10142-1:2012 and SANS 10142-2:2012.

**REVISIONS**

No.	DATE	REVISION	BY
01	16/03/21	NOTICE TO PROCEED	JG
02	16/03/21	FOR TENDER	JG

**public works**  
 Director-General  
 National Road  
 Pretoria 0001

**CONSULTANT**  
 NIKANVENI CONSULTING PTY LTD  
 PO BOX 442  
 1600  
 Tel: +27 (0) 10 507366  
 Fax: +27 (0) 10 507369

**CLIENT**  
 BARTSCH  
 ELECTRICAL

**PROJECT**  
 WESTVILLE DCOS - PROVISION OF FACILITIES FOR THE DISABLED DURBAN MEDIUM PRISON, HARRY GWAHL ROAD, WESTVILLE, 3629

**WCS number:** WCS 049089

**DATE:** 31/12/2021  
**BY:** J GILLESPIE  
**DATE:** 21/01/2013  
**BY:** M WALKER

**PROJECT NUMBER:** EE10414/BI/01













